

| Modelo | Capacidad litros | | Tablero | | Dimensiones | | | | Peso Kg. | C.d.g. | | P.V.P. € | |
|----------|------------------|------|---------|---------|-------------|------|------|------|----------|--------|--------|----------|-------|
| | Colmda. | Rasa | FEM | Cilind. | L | L1 | D | A | | F | Cucha. | | Carga |
| 21 CH1-A | 360 | 300 | II/III | 2 | 750 | 1046 | 1000 | 680 | 800 | 261 | 365 | 553 | 2.600 |
| 21 CH1-B | 432 | 360 | II/III | 2 | 750 | 1046 | 1200 | 680 | 800 | 281 | 380 | 555 | 2.850 |
| 21 CH1-C | 510 | 425 | II/III | 2 | 750 | 1046 | 1400 | 680 | 800 | 301 | 393 | 557 | 2.900 |
| 21 CH1-D | 600 | 500 | II/III | 2 | 750 | 1046 | 1600 | 680 | 800 | 322 | 404 | 559 | 3.376 |
| 21 CH1-E | 660 | 550 | II/III | 2 | 750 | 1046 | 1800 | 680 | 800 | 342 | 414 | 560 | 3.466 |
| 21 CH1-F | 720 | 600 | II/III | 2 | 750 | 1046 | 2000 | 680 | 800 | 362 | 423 | 561 | 3.500 |
| 21 CH1-G | 780 | 650 | II/III | 2 | 750 | 1046 | 2200 | 680 | 800 | 382 | 431 | 562 | 3.705 |
| 22 CH1-A | 504 | 420 | II/III | 2 | 850 | 1113 | 1030 | 800 | 800 | 295 | 414 | 595 | 2.625 |
| 22 CH1-B | 600 | 500 | II/III | 2 | 850 | 1113 | 1230 | 800 | 800 | 318 | 428 | 596 | 2.650 |
| 22 CH1-C | 720 | 600 | II/III | 2 | 850 | 1113 | 1430 | 800 | 800 | 342 | 441 | 597 | 2.850 |
| 22 CH1-D | 840 | 700 | II/III | 2 | 850 | 1113 | 1630 | 800 | 800 | 365 | 451 | 598 | 3.782 |
| 22 CH1-E | 960 | 800 | II/III | 2 | 850 | 1113 | 1830 | 800 | 800 | 388 | 460 | 598 | 3.350 |
| 22 CH1-F | 1080 | 900 | II/III | 2 | 850 | 1113 | 2030 | 800 | 800 | 411 | 469 | 599 | 3.373 |
| 22 CH1-G | 1200 | 1000 | II/III | 2 | 850 | 1113 | 2230 | 800 | 800 | 435 | 476 | 599 | 3.998 |
| 22 CH1-H | 1320 | 1100 | II/III | 2 | 850 | 1113 | 2430 | 800 | 800 | 458 | 482 | 600 | 4.066 |
| 23 CH1-A | 900 | 750 | II/III | 2 | 1275 | 1538 | 1000 | 1000 | 800 | 427 | 561 | 712 | 3.935 |
| 23 CH1-B | 1080 | 900 | II/III | 2 | 1275 | 1538 | 1200 | 1000 | 800 | 465 | 575 | 715 | 4.102 |
| 23 CH1-C | 1260 | 1050 | II/III | 2 | 1275 | 1538 | 1400 | 1000 | 800 | 503 | 587 | 717 | 4.246 |
| 23 CH1-D | 1440 | 1200 | II/III | 2 | 1275 | 1538 | 1600 | 1000 | 800 | 541 | 597 | 719 | 4.418 |
| 23 CH1-E | 1620 | 1350 | II/III | 2 | 1275 | 1538 | 1800 | 1000 | 800 | 579 | 607 | 720 | 4.557 |
| 23 CH1-F | 1800 | 1500 | II/III | 2 | 1275 | 1538 | 2000 | 1000 | 800 | 617 | 615 | 721 | 4.715 |
| 23 CH1-G | 1980 | 1650 | II/III | 2 | 1275 | 1538 | 2200 | 1000 | 800 | 655 | 622 | 722 | 4.886 |

Cuchara hidráulica, apta para la manipulación de toda clase de sustancias sueltas, (Hormigón, arena, chatarra, harinas, cereales, tubérculos, líquidos etc.) gracias a su gran giro en descarga y recogida, la manipulación y transporte se realiza con gran comodidad. La incorporación standard de enganches rápidos, facilita el montaje o desmontaje del accesorio en pocos minutos.

Incorpora antiretorno pilotado, para asegurar la permanencia estática de los cilindros.



Laterales abiertos

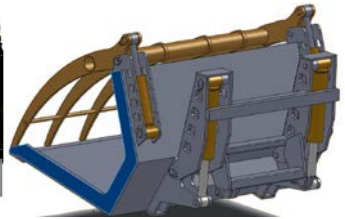
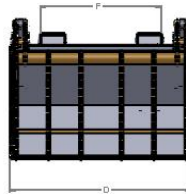
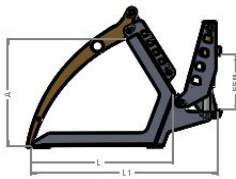

| Modelo | Capacidad dm3 | Tablero | | Dimensiones | | | | Peso Kg. | C.d.g. | | P.V.P. € | | |
|--------------|------------------|---------|--------|-------------|-----|------|------|-------------|--------|-----|-------------|--------|-------|
| | | Rasa | FEM | Cilind. | L | L1 | D | | A | F | | Cucha. | Carga |
| 22 CH1-GR2-B | 575 | | II/III | 2 | 935 | 1225 | 1230 | 950 | 800 | 436 | 517 | 596 | 6.766 |
| 22 CH1-GR2-C | 650 | | II/III | 2 | 935 | 1225 | 1430 | 950 | 800 | 471 | 530 | 597 | 7.048 |
| 22 CH1-GR2-D | 750 | | II/III | 2 | 935 | 1225 | 1630 | 950 | 800 | 499 | 538 | 598 | 7.470 |
| 22 CH1-GR2-E | 850 | | II/III | 2 | 935 | 1255 | 1830 | 950 | 800 | 527 | 544 | 598 | 7.765 |
| 22 CH1-GR2-F | 950 | | II/III | 2 | 935 | 1225 | 2030 | 950 | 800 | 555 | 549 | 599 | 7.993 |

Laterales cerrados

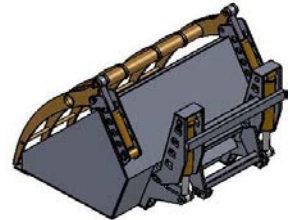
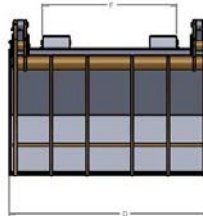
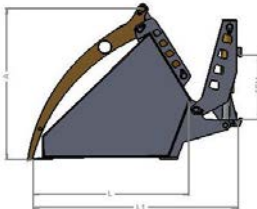

| Modelo | Capacidad dm3 | Rasa | Tablero | | Dimensiones | | | | Peso Kg. | C.d.g. | | P.V.P. € | |
|--------------|------------------|------|---------|---------|-------------|------|------|-----|-------------|--------|--------|-------------|-------|
| | | | FEM | Cilind. | L | L1 | D | A | | F | Cucha. | | Carga |
| 22 CH1-GR1-B | 575 | 500 | II/III | 2 | 935 | 1225 | 1230 | 950 | 800 | 448 | 518 | 596 | 6.773 |
| 22 CH1-GR1-C | 650 | 600 | II/III | 2 | 935 | 1225 | 1430 | 950 | 800 | 483 | 531 | 597 | 7.058 |
| 22 CH1-GR1-D | 750 | 700 | II/III | 2 | 935 | 1225 | 1630 | 950 | 800 | 511 | 538 | 598 | 7.471 |
| 22 CH1-GR1-E | 850 | 800 | II/III | 2 | 935 | 1225 | 1830 | 950 | 800 | 539 | 544 | 598 | 7.768 |
| 22 CH1-GR1-F | 950 | 900 | II/III | 2 | 935 | 1225 | 2030 | 950 | 800 | 567 | 549 | 599 | 7.995 |

Son necesarias dos funciones hidráulicas.

La grapa hidráulica, permite la manipulación de cargas inestables, mediante la presión de la grapa hidráulica sobre la carga

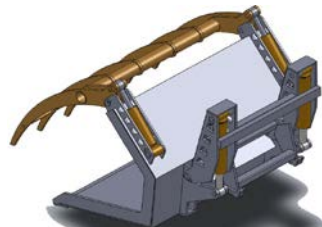

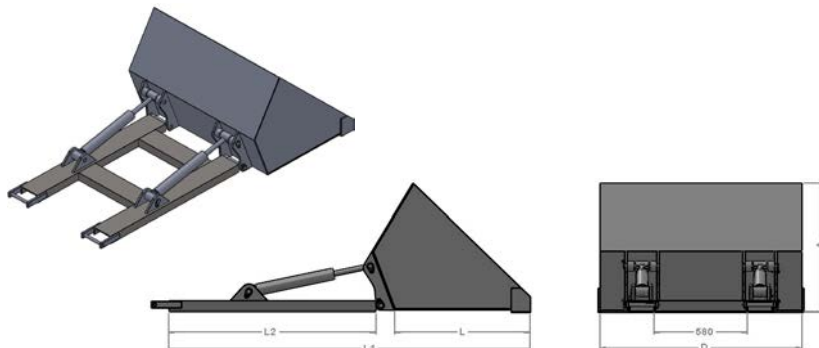

| Modelo | Capacidad litros | | Cilin. | Dimensiones | | | | Peso Kg. | c.d.g. | | P.V.P. € |
|----------|------------------|------|--------|-------------|------|------|------|-------------|--------|-------|-------------|
| | colmad. | rasa | | L | L1 | D | A | | Cucha | Carga | |
| 1 CHH1-A | 360 | 300 | 2 | 750 | 1618 | 1000 | 550 | 246 | 1151 | 1490 | 2.815 |
| 1 CHH1-B | 420 | 350 | 2 | 750 | 1618 | 1200 | 550 | 266 | 1179 | 1492 | 2.887 |
| 1 CHH1-C | 510 | 425 | 2 | 750 | 1618 | 1400 | 550 | 286 | 1202 | 1494 | 2.957 |
| 1 CHH1-D | 576 | 480 | 2 | 750 | 1618 | 1600 | 550 | 306 | 1222 | 1496 | 3.083 |
| 1 CHH1-E | 648 | 540 | 2 | 750 | 1618 | 1800 | 550 | 327 | 1240 | 1497 | 3.238 |
| 1 CHH1-F | 720 | 600 | 2 | 750 | 1618 | 2000 | 550 | 347 | 1256 | 1498 | 3.535 |
| 1 CHH1-G | 780 | 650 | 2 | 750 | 1618 | 2200 | 550 | 367 | 1270 | 1499 | 3.638 |
| 2 CHH1-A | 504 | 420 | 2 | 850 | 1768 | 1030 | 800 | 280 | 1219 | 1532 | 3.097 |
| 2 CHH1-B | 600 | 500 | 2 | 850 | 1768 | 1230 | 800 | 303 | 1243 | 1533 | 3.151 |
| 2 CHH1-C | 720 | 600 | 2 | 850 | 1768 | 1430 | 800 | 326 | 1265 | 1534 | 3.255 |
| 2 CHH1-D | 840 | 700 | 2 | 850 | 1768 | 1630 | 800 | 350 | 1283 | 1535 | 3.489 |
| 2 CHH1-E | 960 | 800 | 2 | 850 | 1768 | 1830 | 800 | 369 | 1297 | 1535 | 3.602 |
| 2 CHH1-F | 1080 | 900 | 2 | 850 | 1768 | 2030 | 800 | 396 | 1314 | 1536 | 3.647 |
| 3 CHH1-F | 1080 | 900 | 2 | 1275 | 2193 | 1200 | 1000 | 450 | 1429 | 1649 | 3.642 |
| 3 CHH1-G | 1260 | 1050 | 2 | 1275 | 2193 | 1400 | 1000 | 488 | 1448 | 1652 | 3.809 |
| 3 CHH1-H | 1440 | 1200 | 2 | 1275 | 2193 | 1600 | 1000 | 526 | 1464 | 1654 | 3.953 |
| 3 CHH1-I | 1800 | 1500 | 2 | 1275 | 2193 | 1800 | 1000 | 564 | 1478 | 1656 | 4.125 |

Debe respetarse la capacidad de carga del resultado de unir el implemento con la carretilla

Cuchara hidráulica, colocada sobre fundas, para una rápida toma de la misma, idónea en aquellos trabajos que requiere un constante cambio del equipo de trabajo. Debe tenerse en cuenta el desplazamiento del centro de gravedad al extremo de las horquillas, por lo que deberá sumarse la longitud de estas la efectuar el calculo de la capacidad residual.



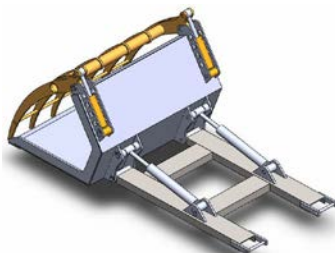
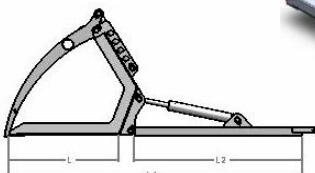
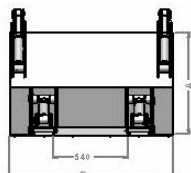

| Modelo | Capacidad litros | | Cilin. | Dimensiones | | | | peso Kg. | c.d.g. | | P.V.P. € |
|--------------|------------------|------|--------|-------------|------|------|-----|-------------|--------|--------|-------------|
| | colmad. | rasa | | L | L1 | D | A | | Cucha | caarga | |
| 2 CHH1-GR2-B | 575 | | 2 | 850 | 1768 | 1230 | 800 | 440 | 1380 | 1533 | 6.137 |
| 2 CHH1-GR2-C | 650 | | 2 | 850 | 1768 | 1430 | 800 | 468 | 1392 | 1534 | 6.392 |
| 2 CHH1-GR2-D | 750 | | 2 | 850 | 1768 | 1630 | 800 | 496 | 1404 | 1535 | 6.645 |
| 2 CHH1-GR2-E | 850 | | 2 | 850 | 1768 | 1830 | 800 | 524 | 1414 | 1535 | 6.954 |
| 2 CHH1-GR2-F | 950 | | 2 | 850 | 1768 | 2030 | 800 | 552 | 1423 | 1536 | 7.227 |

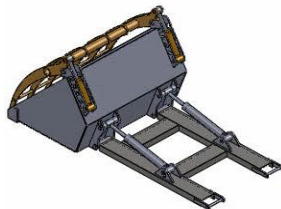
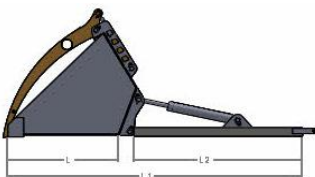
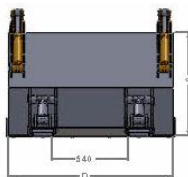

| Modelo | Capacidad litros | | Cilin. | Dimensiones | | | | peso Kg. | c.d.g. | | P.V.P. € |
|--------------|------------------|------|--------|-------------|------|------|-----|-------------|--------|-------|-------------|
| | colmad. | rasa | | L | L1 | D | A | | Cucha | Carga | |
| 2 CHH1-GR1-B | 575 | 500 | 2 | 850 | 1768 | 1230 | 800 | 446 | 1381 | 1533 | 6.183 |
| 2 CHH1-GR1-C | 650 | 600 | 2 | 850 | 1768 | 1430 | 800 | 472 | 1393 | 1534 | 6.425 |
| 2 CHH1-GR1-D | 750 | 700 | 2 | 850 | 1768 | 1630 | 800 | 501 | 1406 | 1535 | 6.687 |
| 2 CHH1-GR1-E | 850 | 800 | 2 | 850 | 1768 | 1830 | 800 | 532 | 1415 | 1535 | 6.995 |
| 2 CHH1-GR1-F | 950 | 900 | 2 | 850 | 1768 | 2030 | 800 | 560 | 1425 | 1536 | 7.253 |

Debe respetarse la capacidad de carga del resultado de unir el implemento con la carretilla

Cuchara hidráulica, colocada sobre fundas, para una rápida toma de la misma, idónea en aquellos trabajos que requiere un constante cambio del equipo de trabajo.

Debe tenerse en cuenta el desplazamiento del centro de gravedad al extremo de las horquillas, por lo que deberá sumarse la longitud de estas la efectuar el calculo de la capacidad residual.

